

Radiator connection plug

Item number 2350541203

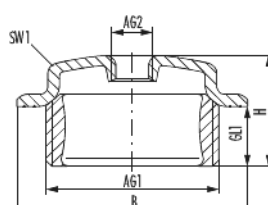

Technical data

Connection size 1 (AG1)	G 1 1/4
Thread direction (AG1)	left
Connection size 2 (AG2)	G 1/2
Connection type 1 (AT1)	External thread
Connection type 2 (AT2)	Internal thread
Length (L)	56 mm
Width (B)	56 mm
Height (H)	27.2 mm
Thread Length 1 (GL1)	14.5 mm
Wrench size 1 (SW1)	41 mm
Suitable for	Radiators
Mounting form	Straight-type
Material	Steel
Max. operating pressure	10 bar

Radiator connection plug

Item number 2350541203

**Max. operating temperature
heating** 90 °C

Commercial data

Packaging Unit	100
EAN code	4033878100752
Weight	0.112 kg
ETIM 7	EC003024
ETIM 8	EC003024
ETIM 9	EC003024
eCl@ss 10.1	22-56-92-90
Customs tariff number	73221900

Note:

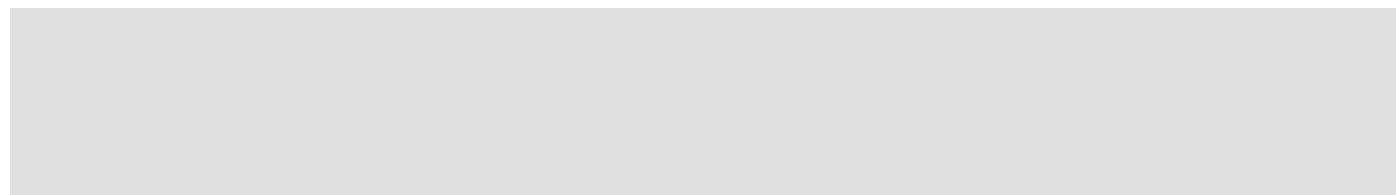

Radiator connection plug

Item number 2350541203