

Contact insert M23 Signal - 17-pole (solder)

Item number 7001917103

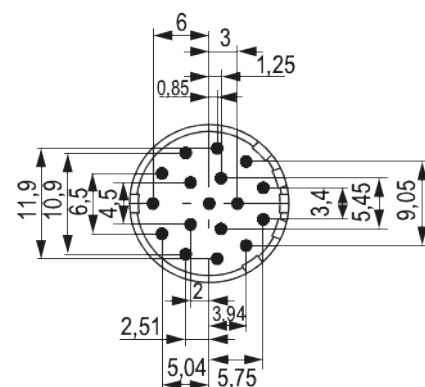
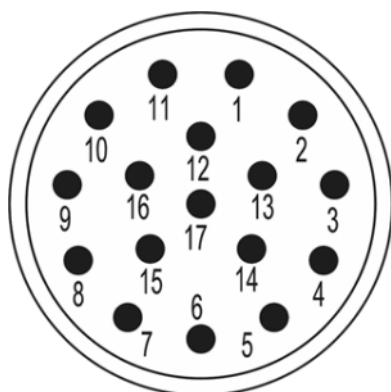

Technical data

Characteristic of connection	Solder
Number of poles	17
Pole picture	17
direction of rotation	Pinout clockwise
Insert	Pin
Color contact insert	white
Material insulating body	PA 6 , PBT
Number of contacts signal	17
Contact-Ø signal	1 mm
Nominal current signal	8 A
Nominal voltage at degree of pollution 3 signal	160 V~
Test voltage signal	500 V~
Insulation resistance signal	> 10 ⁸ Ω
max. contact resistance signal	3 mOhm
Temperature range	-40°C to +125°C



Contact insert M23 Signal - 17-pole (solder)

Item number 7001917103

Degree of Protection	3
Flammability	V-0 (UL 94)



Contact insert M23 Signal - 17-pole (solder)

Item number 7001917103

Commercial data

Packaging Unit	25
EAN code	4033878500583
Weight	0.00712 kg
ETIM 7	EC003557
ETIM 8	EC003557
ETIM 9	EC003557
eCl@ss 10.1	27440223
Customs tariff number	85369010

Note:

