

# Contact insert M23 Signal - 17-pole (solder in)

Item number 7001917108

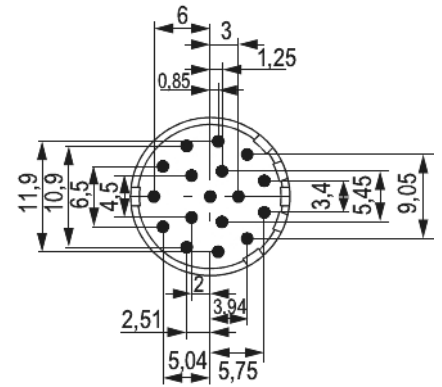
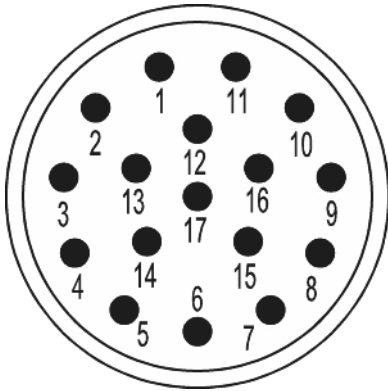

## Technical data

Characteristic of connection	PCB assembly
Number of poles	17
Pole picture	17
	Pinout clockwise
Dip solder contacts length	10 mm
Insert	Socket
Color contact insert	white
Material insulating body	PA 6 , PBT
Number of contacts signal	17
Contact-Ø signal	1 mm
Nominal current signal	8 A
Nominal voltage at degree of pollution 3 signal	160 V~
Test voltage signal	1500 V~
Insulation resistance signal	> 10 <sup>6</sup>
max. contact resistance signal	3 mOhm



# Contact insert M23 Signal - 17-pole (solder in)

Item number 7001917108

max. contact resistance power	3 mOhm
Temperature range	-40°C to +125°C
Degree of Protection	3
Flammability	V-0 (UL 94)



# Contact insert M23 Signal - 17-pole (solder in)

Item number 7001917108

## Commercial data

Packaging Unit	25
EAN code	4033878500613
Weight	0.00246 kg
ETIM 7	EC003557
ETIM 8	EC003557
ETIM 9	EC003557
eCl@ss 10.1	27440223
Customs tariff number	85366930

Note:

