

Contact insert M23 Signal - 17-pole (solder in)

Item number 7001917118

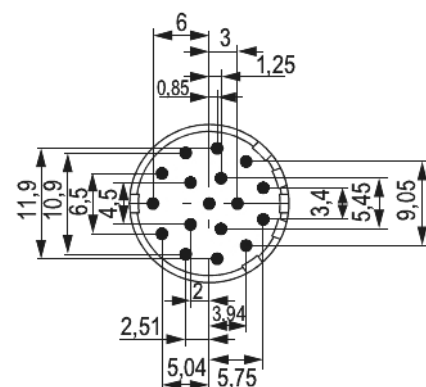
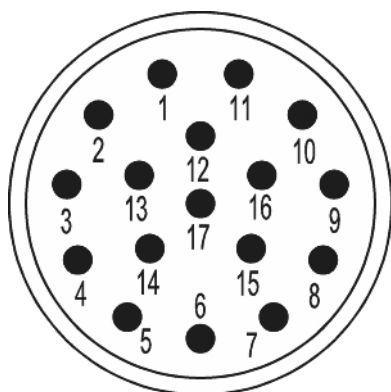

Technical data

Characteristic of connection	PCB assembly
Number of poles	17
Pole picture	17
	Pinout clockwise
Dip solder contacts length	17 mm
Insert	Socket
Color contact insert	white
Material insulating body	PA 6 , PBT
Number of contacts signal	17
Contact-Ø signal	1 mm
Nominal current signal	8 A
Nominal voltage at degree of pollution 3 signal	160 V~
Test voltage signal	500 V~
Insulation resistance signal	> 10 ⁸
max. contact resistance signal	3 mOhm



Contact insert M23 Signal - 17-pole (solder in)

Item number 7001917118

Temperature range	-40°C to +125°C
-------------------	-----------------

Degree of Protection	3
----------------------	---

Flammability	V-0 (UL 94)
--------------	-------------



Contact insert M23 Signal - 17-pole (solder in)

Item number 7001917118

Commercial data

Packaging Unit	25
EAN code	4033878500620
Weight	0.00246 kg
ETIM 7	EC003557
ETIM 8	EC003557
ETIM 9	EC003557
eCl@ss 10.1	27440223
Customs tariff number	85366930

Note:

