

Contact insert M23 Signal - 19-pole (solder in)

Item number 7001919127

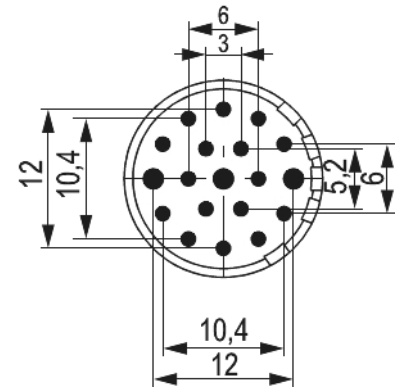
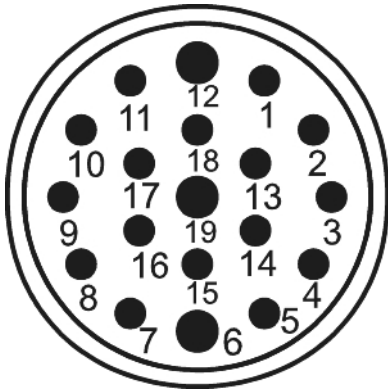

Technical data

Characteristic of connection	PCB assembly
Number of poles	19
Pole picture	19
	Pinout clockwise
Dip solder contacts length	10 mm
Insert	Pin
Color contact insert	white
Material insulating body	PA 6 , PBT
Number of contacts signal	16
Number of contacts power	3
Contact-Ø signal	1 mm
Contact-Ø power	1.5 mm
Nominal current signal	8 A
Nominal current power	10 A
Nominal voltage at degree of pollution 3 signal	110 V~



Contact insert M23 Signal - 19-pole (solder in)

Item number 7001919127

Nominal voltage at degree of pollution 3 power	110 V~
Test voltage signal	370 V~
Test voltage power	840 V~
Insulation resistance signal	> 10 ⁸
Insulation resistance power	> 10 ⁸
max. contact resistance signal	3 mOhm
max. contact resistance power	3 mOhm
Temperature range	-40°C to +125°C
Degree of Protection	3
Flammability	V-0 (UL 94)



Contact insert M23 Signal - 19-pole (solder in)

Item number 7001919127

Commercial data

Packaging Unit	25
EAN code	4033878500736
Weight	0.00346 kg
ETIM 7	EC003557
ETIM 8	EC003557
ETIM 9	EC003557
eCl@ss 10.1	27440223
Customs tariff number	85369010

Note:

