

Contact insert M23 Signal - 9-pole (solder in)

Item number 7002981137

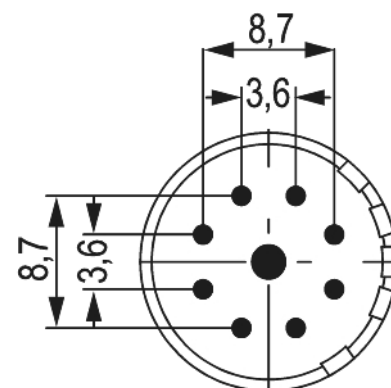
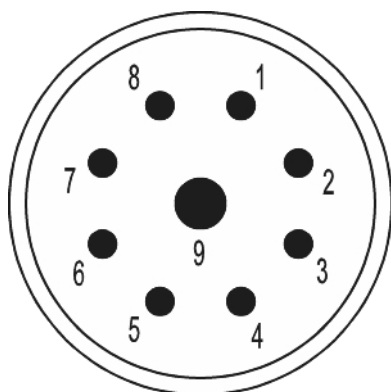

Technical data

Characteristic of connection	PCB assembly
Number of poles	9
Pole picture	8 + 1
	Pinout counter-clockwise
Dip solder contacts length	17 mm
Insert	Pin
Color contact insert	white
Material insulating body	PA 6 , PBT
Number of contacts signal	8
Number of contacts power	1
Contact-Ø signal	1 mm
Contact-Ø power	2 mm
Nominal current signal	8 A
Nominal current power	20 A
Nominal voltage at degree of pollution 3 signal	200 V~

Contact insert M23 Signal - 9-pole (solder in)

Item number 7002981137

Nominal voltage at degree of pollution 3 power	200 V~
Test voltage signal	1500 V~
Test voltage power	1500 V~
Insulation resistance signal	$> 10^8$
Insulation resistance power	$> 10^8$
max. contact resistance signal	3 mOhm
max. contact resistance power	3 mOhm
Temperature range	-40°C to +125°C
Degree of Protection	3
Flammability	V-0 (UL 94)

Contact insert M23 Signal - 9-pole (solder in)

Item number 7002981137

Commercial data

Packaging Unit	5
EAN code	4033878501245
Weight	0.00346 kg
ETIM 7	EC003557
ETIM 8	EC003557
ETIM 9	EC003557
eCl@ss 10.1	27440223
Customs tariff number	85366930

Note:

