

Contact insert M23 Signal - 9-pole

Item number 7003981101

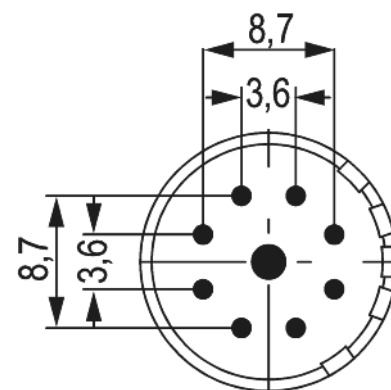
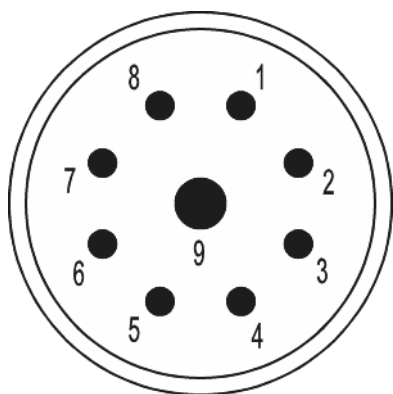

Technical data

| | |
|---|----------------------------|
| Characteristic of connection | Crimp |
| Number of poles | 9 |
| Pole picture | 8 + 1 |
| | Pinout clockwise |
| Insert | Pin |
| Color contact insert | white |
| Material insulating body | PA 6 , PBT |
| Number of contacts signal | 8 |
| Number of contacts power | 1 |
| Contact-Ø signal | 1 mm |
| Contact-Ø power | 2 mm |
| Terminal cross section power | 0,75 - 2,5 mm ² |
| Nominal current signal | 8 A |
| Nominal current power | 20 A |
| Nominal voltage at degree of pollution 3 signal | 200 V [~] |



Contact insert M23 Signal - 9-pole

Item number 7003981101

| | |
|--|-----------------|
| Nominal voltage at degree of pollution 3 power | 200 V~ |
| Test voltage signal | 1500 V~ |
| Test voltage power | 1500 V~ |
| Insulation resistance signal | $> 10^8$ |
| Insulation resistance power | $> 10^8$ |
| max. contact resistance signal | 3 mOhm |
| max. contact resistance power | 3 mOhm |
| Temperature range | -40°C to +125°C |
| Degree of Protection | 3 |
| Flammability | V-0 (UL 94) |



Contact insert M23 Signal - 9-pole

Item number 7003981101

Commercial data

| | |
|-----------------------|---------------|
| Packaging Unit | 5 |
| EAN code | 4033878501542 |
| Weight | 0.0022 kg |
| ETIM 7 | EC003557 |
| ETIM 8 | EC003557 |
| ETIM 9 | EC003557 |
| eCl@ss 10.1 | 27440223 |
| Customs tariff number | 85469010 |

Note:

