

Contact insert M23 Signal - 9-pole

Item number 7004981102

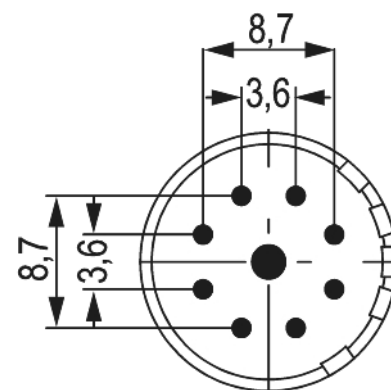
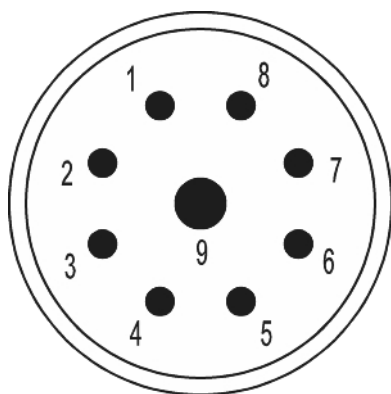

Technical data

Characteristic of connection	Crimp
Number of poles	9
Pole picture	8 + 1
	Pinout counter-clockwise
Insert	Socket
Color contact insert	white
Material insulating body	PA 6 , PBT
Number of contacts signal	8
Number of contacts power	1
Contact-Ø signal	1 mm
Contact-Ø power	2 mm
Terminal cross section power	0,75 - 2,5 mm ²
Nominal current signal	8 A
Nominal current power	20 A
Nominal voltage at degree of pollution 3 signal	200 V [~]



Contact insert M23 Signal - 9-pole

Item number 7004981102

Nominal voltage at degree of pollution 3 power	200 V~
Test voltage signal	1500 V~
Test voltage power	1500 V~
Insulation resistance signal	$> 10^8$
Insulation resistance power	$> 10^8$
max. contact resistance signal	3 mOhm
max. contact resistance power	3 mOhm
Temperature range	-40°C to +125°C
Degree of Protection	3
Flammability	V-0 (UL 94)



Contact insert M23 Signal - 9-pole

Item number 7004981102

Commercial data

Packaging Unit	5
EAN code	4033878501696
Weight	0.00146 kg
ETIM 7	EC003557
ETIM 8	EC003557
ETIM 9	EC003557
eCl@ss 10.1	27440223
Customs tariff number	85469010

Note:

