

Housing TWILOCK-S panel connector M40

Power angled

Item number 774904300S

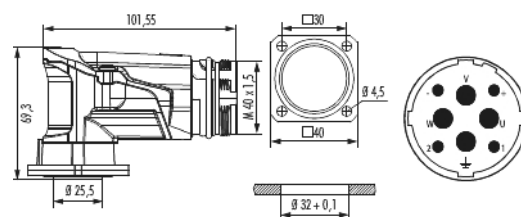

Technical data

Housing type	Panel angled
Material housing	Zinc Die Cast
Material housing surface	blue passivated
Insert	Pin
Version	right angled , TWILOCK-S
External thread plug-in side	M40 x 1,5
TWILOCK thread	M40 x 1,5
Shield	unshielded
Seal type	O-Ring
Material seals/o-rings	FKM (FPM) , HNBR
Rotatable	330 °
Panel hole	Ø 32 + 0,1 mm
Flange	40 x 40 mm
Hole distance	30 mm
Hole diameter	4 x Ø 4,5 mm
Length (L)	103 mm



Housing TWILOCK-S panel connector M40

Power angled

Item number 774904300S

Allen key/Torx	T20
Temperature range	-40°C to +125°C
Degree of Protection	3
Protection class	IP 67 , IP 69 K
Characteristic of connection	Crimp
Number of poles	8
Pole picture	4 + 3 + PE
Color contact insert	blue
Material insulating body	PBT
Number of contacts signal	4
Number of contacts power	3
Number of contacts PE	1
Contact-Ø signal	2 mm
Contact-Ø power	3.6 mm
Terminal cross section signal	0,14 – 1,5 mm ²
Terminal cross section power	2,5 – 10 mm ²
Crimp range	0.14 – 10 mm ²
Nominal current signal	28 A
Nominal current power	55 A
Nominal voltage at degree of pollution 3 signal	300 V~
Nominal voltage at degree of pollution 3 power	600 V~
Test voltage signal	2500 V~
Test voltage power	4000 V~



Housing TWILOCK-S panel connector M40

Power angled

Item number 774904300S

Insulation resistance signal	> 10 ¹³
Insulation resistance power	> 10 ¹³
max. contact resistance data	3 mOhm
max. contact resistance signal	3 mOhm
max. contact resistance power	1 mOhm
Minimum mating cycles	> 500

Housing TWILOCK-S panel connector M40

Power angled

Item number 774904300S

Commercial data

Packaging Unit	10
EAN code	4033878010754
Weight	0.4779 kg
ETIM 7	EC002635
ETIM 8	EC002635
ETIM 9	EC002635
eCl@ss 10.1	27440102
Customs tariff number	85366990

Note:

